

COMUNE DI MONTALCINO

INTERVENTO DI RISTRUTTURAZIONE EDILIZIA RICOSTRUTTIVA AI SENSI DELL'ART. 134 L.R. 65/2014 PER AMPLIAMENTO DI STRUTTURA RICETTIVA RICHIESTA DI PERMESSO DI COSTRUIRE

UBICAZIONE: Strada Provinciale 103 - loc.à Castiglion del Bosco - Montalcino

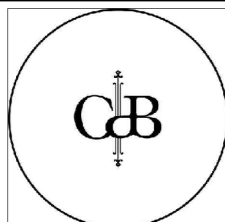

PROPRIETÀ: CASTIGLION DEL BOSCO Hotel S.r.l.
 Località Castiglion del Bosco, 53024 Montalcino

ELABORATO: STATO DI PROGETTO - PIANTE PIANO -1
 scala 1:100

Tavola
09
 30.08.2016

Firma del legale rappresentante

Firma del Progettista

STATO DI PROGETTO - RIEPILOGO SUPERFICI - PIANO -1						
DESTINAZIONE D'USO DEI LOCALI	ALTEZZA LOCALE	SUPERFICIE LOCALE	SUPERFICIE FINISTRATA	RAPPORTO ABBUZZAMENTO S. L. R. - S. I. S. E.	AREAZIONE FORZATA	
FORNO						
-100 CAMERA	3,20	20,37	0,17	0,204		
-101 INGRESSO/ARMADIO	3,20	7,35	---	---		
-102 BAGNO	2,20	11,47	1,08	0,09	*	
-103 DISIMPIEGNO	2,20	7,98	---	---		
LIMONAIA						
-104 POTER	2,25	9,35	---	---		
-105 INGRESSO	2,25	3,82	---	---		
-106 DISIMPIEGNO	2,75	4,89	---	---		
-107 BAGNO	2,75	11,87	---	---		*
-108 CAMERA	3,20	22,54	6,77	0,30		
-109 INGRESSO	2,75	3,40	---	---		
-110 DISIMPIEGNO	2,75	4,75	---	---		
-111 BAGNO	2,75	3,74	---	---		*
-112 SOGGIORNO	3,20	28,56	5,58	0,195		
-113 DISIMPIEGNO	2,75	4,75	---	---		
-114 DISIMPIEGNO ARMADIO	2,75	6,97	---	---		
-115 BAGNO	2,75	10,25	---	---		*
-116 CAMERA	3,20	20,86	5,58	0,266		
FRANTOIO						
-117 POTER	2,75	6,20	---	---		
-118 DISIMPIEGNO	2,75	5,51	---	---		
-119 BAGNO	2,75	11,00	---	---		*
-120 CAMERA	3,20	22,56	4,40	0,195		
-121 DISIMPIEGNO	2,75	5,51	---	---		
-122 BAGNO	2,75	11,00	---	---		*
-123 CAMERA	3,20	22,56	3,19	0,141		
-124 VANO SCALA	2,75	7,78	---	---		
FIENILE						
-125 INGRESSO	2,25	2,28	---	---		
-126 BAGNO	2,25	4,54	---	---		*
-127 SOGGIORNO	4,47 km	30,98	13,38	0,43		
-128 DISIMPIEGNO	2,25	4,53	---	---		
-129 ARMADIO	2,25	3,53	---	---		
-130 BAGNO	2,25	13,76	---	---		*
-131 CAMERA	4,47 km	22,21	5,92	0,266		
CASINO CACCIA						
-132 INGRESSO	2,25	3,08	---	---		
-133 BAGNO	2,25	3,08	---	---		*
-134 DISIMPIEGNO	2,25	4,59	---	---		
-135 SOGGIORNO	2,25	23,52	3,19	0,136		
-136 CAMERA	2,25	20,37	3,19	0,157		
-137 DISIMPIEGNO	2,25	3,19	---	---		
-138 ARMADIO	2,25	4,24	---	---		
-139 BAGNO	2,25	13,21	---	---		*
-140 REPOSTIGLIO	2,40	2,54	---	---		
COLOMBATA						
-141 DEPOSITO	2,40	7,72	---	---		
-142 DEPOSITO	2,40	6,84	---	---		
-143 REPOSTIGLIO	2,40	2,28	---	---		
-144 DEPOSITO BICICLETTE	2,40	27,91	---	---		
-145 VANO SCALA	2,25	27,91	---	---		
-146 DEPOSITO RIFIUTI	2,40	17,51	---	---		
-147 MAGAZZINO BIANCHERIA	2,40	7,58	---	---		
-148 MAGAZZINO BIANCHERIA	2,40	10,58	---	---		
-149 MC	2,40	4,13	---	---		*
-150 MC	2,40	4,13	---	---		*
-151 MAGAZZINO	2,40	4,25	---	---		
-152 DEPOSITO	2,40	11,71	---	---		
-153 MAGAZZINO	2,40	15,00	---	---		
-154 DEPOSITO	2,40	16,50	---	---		
-155 LOCALE TECNICO	2,25	35,72	---	---		
-156 LOCALE TECNICO	2,25	35,85	---	---		
-155 LOCALE TECNICO	2,25	35,72	---	---		
-156 LOCALE TECNICO	2,25	16,20	---	---		

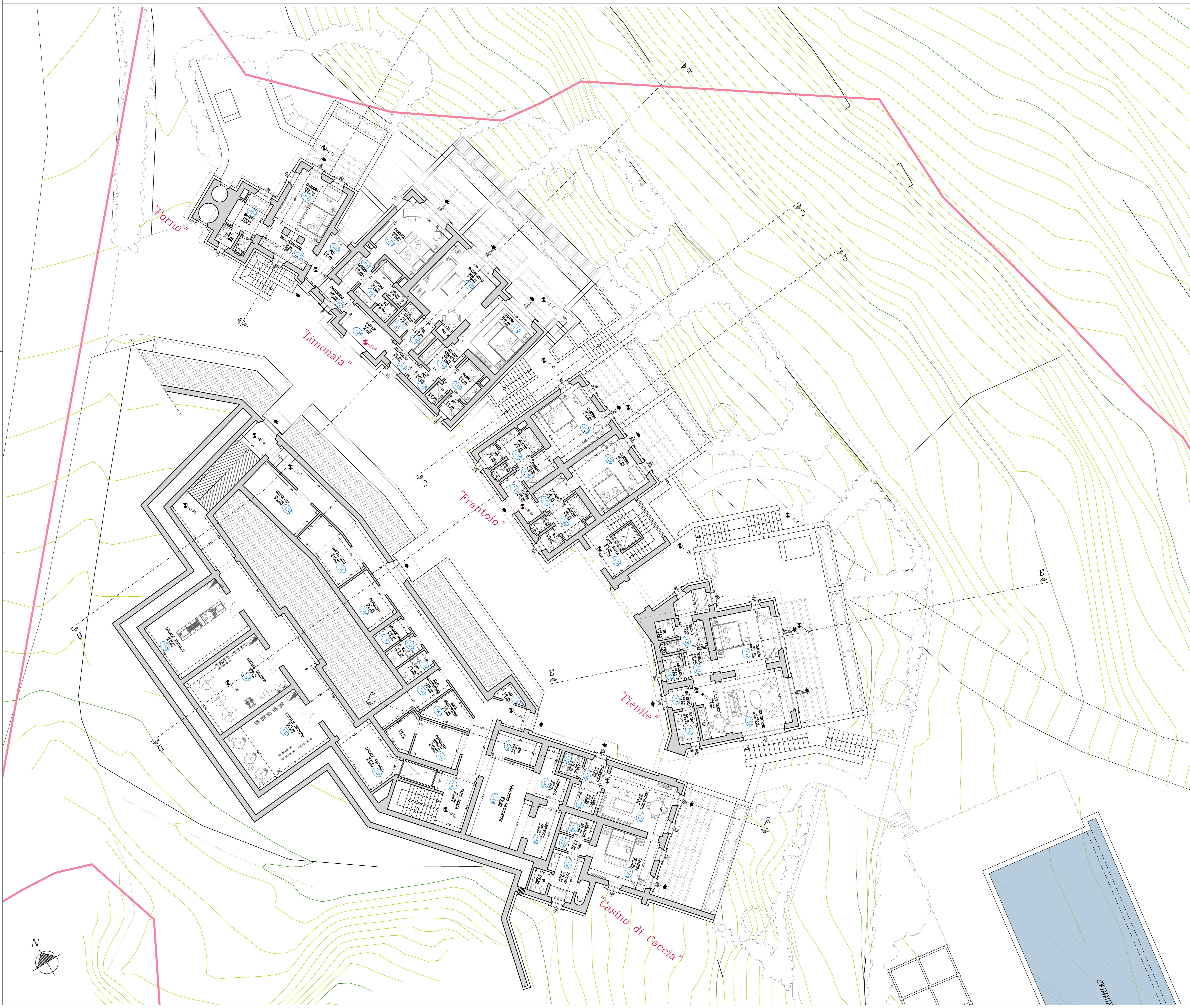

STADIA